



PARTIALLY EXTENDED WHIP ANTENNA OF YOUR RADIO



**COAXIAL CABLE
WITH 'F' CONNECTOR
(FROM THE EXTERNAL
ANTENNA)**



**BALUN SPADE CONNECTOR
ITEM #BLN - \$9.95
(MAY ALSO BE AVAILABLE AT
LOCAL RADIO SHACK OR
APPLIANCE/ HARDWARE STORE)**



**ALLIGATOR CLIP
ITEM #FCP - \$5.00**

**Balun Spade Connector and Alligator Clip
are included with the FM Reflect**

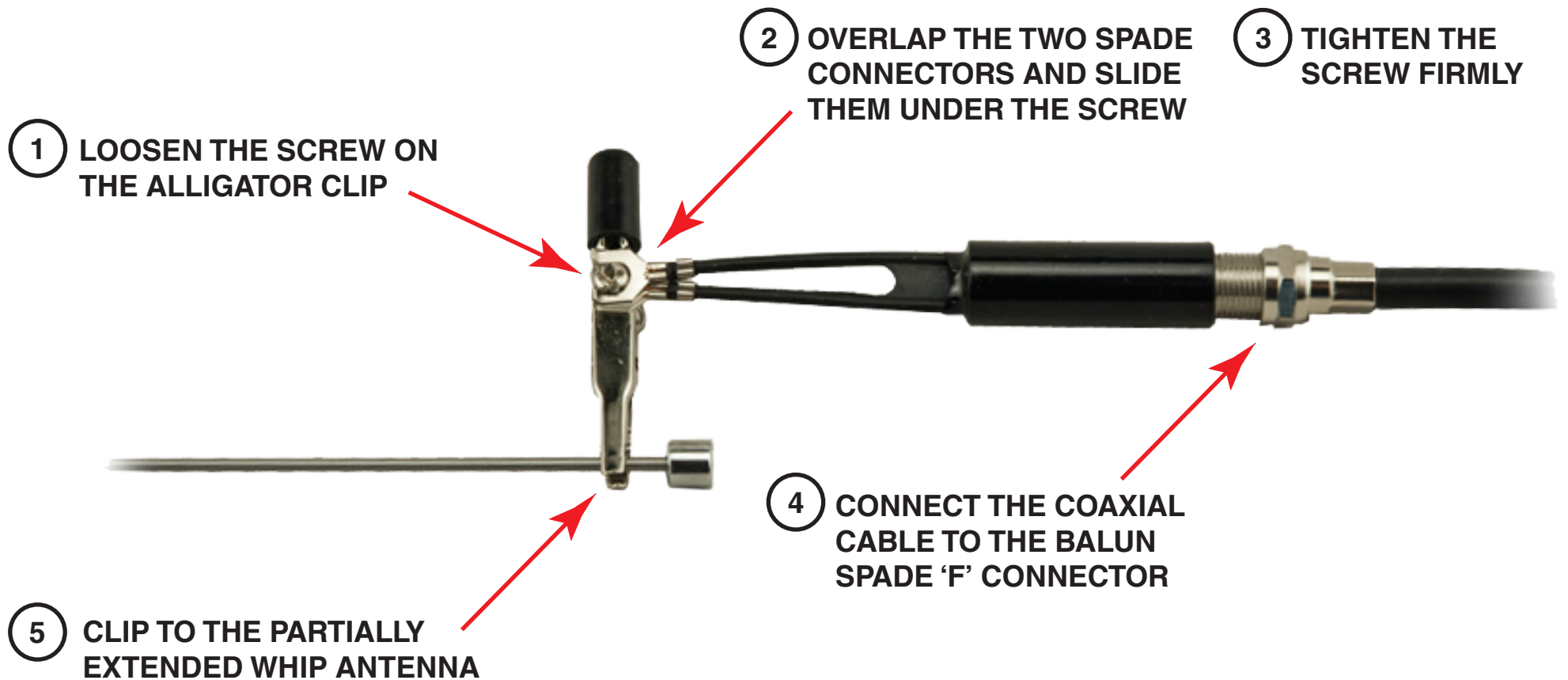

NOTE: DO NOT FULLY EXTEND THE WHIP ANTENNA AS THE WEIGHT OF THE COAX CABLE CAN BREAK IT

YOU MAY NEED TO ADD SUPPORT TO THE CABLE SO THAT IT DOES NOT STRAIN THE ANTENNA OR TIP THE RADIO